

# Main Entrance

These solutions and security tips are for the main entrance to the school. This includes securing the outside doors and vestibules.

For tips on securing administrative offices, see Administrative Offices solutions.

 Learn best practices to secure this opening.



## Locate this opening:

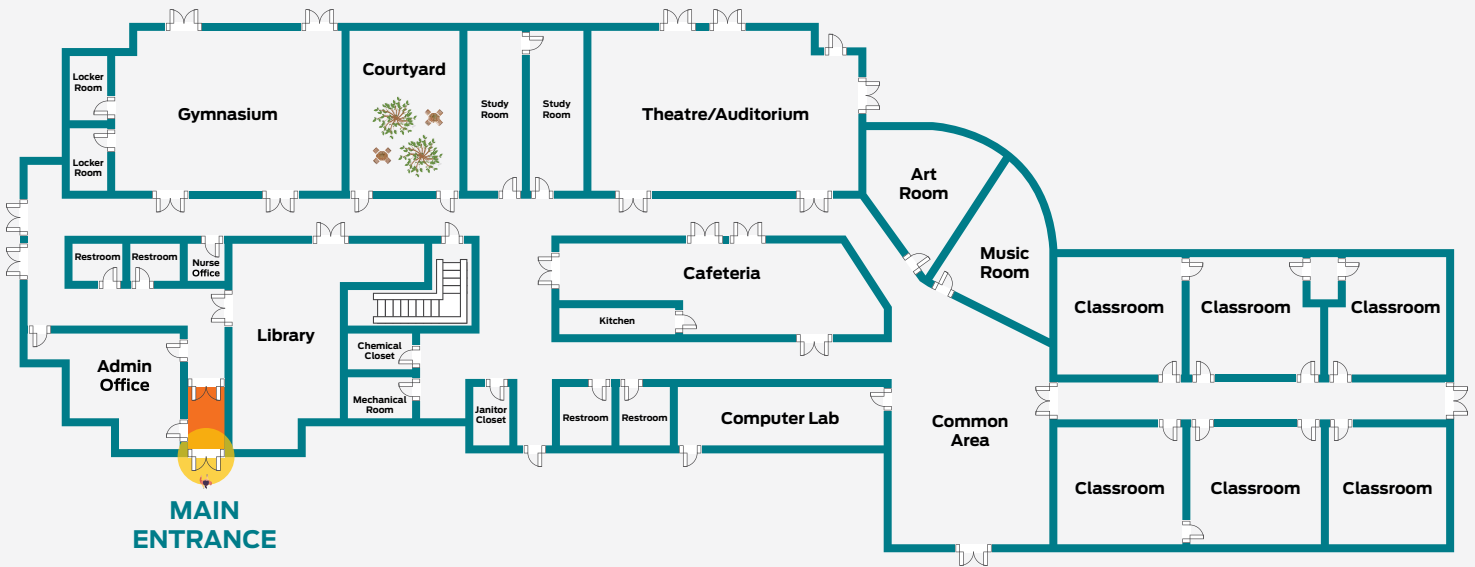

## Operational requirements:



Main entrance doors into the vestibule or school from outside **should always be locked except during arrival times**



All doors from the vestibule into the administration office **should be locked except during arrival times**



**Access is gained by a valid credential, key, or staff release** through the admin office



Free egress is **always available**



Use secured vestibules with **forced entry resistant doors and glazing**



## Recommended products:

Here are some key components for securing the main entrance of a school.

For full solutions, specifications and recommendations, **contact us**.

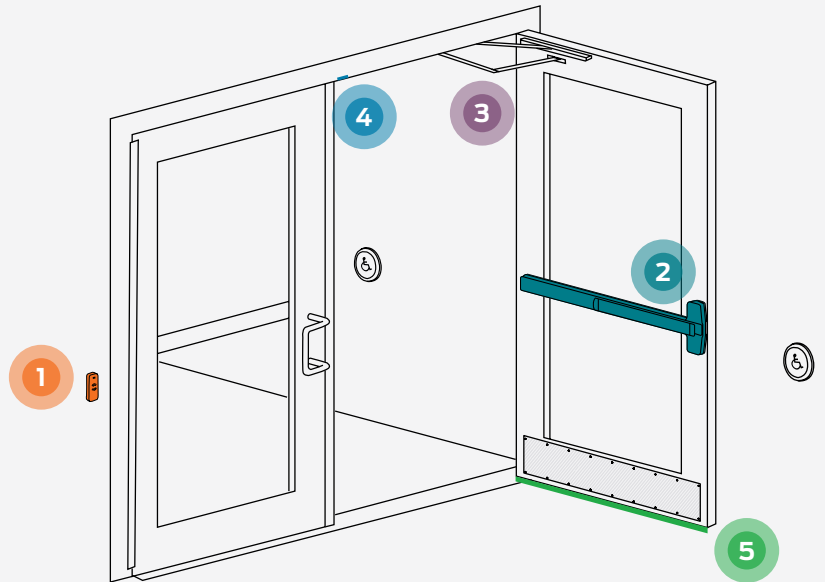

**1** A **multi-technology reader** works with a variety of credential technologies when you have a mix of smart, proximity or magnetic stripe cards. Smart cards provide the highest level of security.

**2** **Panic hardware** is needed to meet fire and life safety codes. Adding electric latch retraction to the panic hardware allows remote operation of these doors. A touchpad style is recommended over a cross bar style panic device to prevent chaining the doors shut.

**3** **Auto operators** are recommended at main entrance for enhanced accessibility for all students. If not an auto operator, include a door closer to ensure that they doors return to a closed, latched and secure position.

**4** **Door and latch-bolt position sensors** alert administration when any exterior door is left open or left unlatched.

**5** Threshold and weather stripping is recommended to seal gaps around the door. This provides weatherization in the winter and improves HVAC efficiency.

Other solutions not shown above



A **remote release push button** inside the office allows staff to remotely release the doors and allow visitors to enter. (Sandy Hook page 52, MSD page 345, PASS page 60)

## Recommendations from commission reports:

The following security recommendations are from past incident reports and the security industry.

- Guide visitors to a single control point for entry. (Sandy Hook page 51, CPTED, PASS page 58)
- Use secured vestibules with forced entry resistant doors and glazing. (Sandy Hook page 52, PASS page 58)
- Main entrance assembly (glazing, frame, & door) should be forced entry resistant. (Sandy Hook page 51, MSD page 348)
- Control visitor access through electronic surveillance with intercom audio/video and remote lock at the visitor entrance. (Sandy Hook page 52, MSD page 345, PASS page 59)
- Secure main entrance doors from a central location, such as the central administrative office and/or the school security office. (Sandy Hook page 51)
- If your main entrance requires keys, use a high security, restricted key system with patented keys and cylinders. Be sure that your patent is still active to prevent duplication of keys.
- For aluminum, glass or steel doors, consider a mid-rail to prevent strapping or chaining of the panic hardware.
- Only one door should be unlocked for visitor entry. Independent release for all other doors in bank of doors, unlocks only for load-in times and relocks at start of school.

Sandy Hook Final Report of the Sandy Hook Advisory Commission, 03/2015 MSD Marjory Stoneman Douglass High School Public Safety Commission, 01/02/2019 FED Final Report of the Federal Commission on School Safety, 12/18/2018 PASS PASS Guidelines, 6th Edition, 2023



To contact an Allegion security consultant, visit  
[us.allegion.com/schoolsecurity](https://us.allegion.com/schoolsecurity)

### About Allegion

Allegion (NYSE: ALLE) is a global pioneer in seamless access, with leading brands like CISA®, Interflex®, LCN®, Schlage®, SimonsVoss® and Von Duprin®. Focusing on security around the door and adjacent areas, Allegion secures people and assets with a range of solutions for homes, businesses, schools and institutions.

For more, visit [www.allegion.com](https://www.allegion.com)

KRYPTONITE ■ LCN ■  ■ STEELCRAFT ■ VON DUPRIN



**ALLEGION™**

© 2023 Allegion  
015663, Rev. 07/23  
[www.allegion.com/us](https://www.allegion.com/us)